

Spare Parts for Valves and Fill Cluster

Type 11C01 - Globe Valve FullX



Disc
for Cryogenic-Globe Valves
stainless steel check disc 1.4301

"cleaned and degreased for oxygen service"

Part No. 11C01.00XX.E00501
suitable for:

Type	Nominal size
11C01.001X.E00501	DN10 - DN15
11C01.002X.E00501	DN20 - DN25
11C01.0032.E00501	DN32
11C01.0040.E00501	DN40
11C01.0050.E00501	DN50

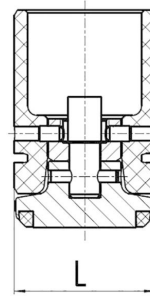

Type 11C01.00XX.E00501	Technical data							
Nominal size	DN	10	15	20	25	32	40	50
Dimension code	.X.	001X	001X	002X	002X	0032	0040	0050
Weight	ca. kg	0.17	0.17	0.23	0.23	0.46	0.46	0.59

Dimensions in mm.

Check Disc
for Cryogenic-Globe Valves
stainless steel check disc 1.4301

"cleaned and degreased for oxygen service"

Part No. 11C01.00XX.E00502
suitable for:

Type	Nominal size
11C01.001X.E00502	DN10 - DN15
11C01.002X.E00502	DN20 - DN25
11C01.0032.E00502	DN32
11C01.0040.E00502	DN40
11C01.0050.E00502	DN50

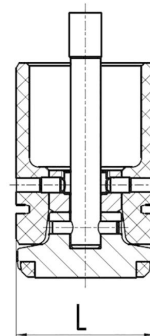

Type 11C01.00XX.E00502	Technical data							
Nominal size	DN	10	15	20	25	32	40	50
Dimension code	.X.	001X	001X	002X	002X	0032	0040	0050
Weight	ca. kg	0.20	0.20	0.25	0.25	0.50	0.50	0.62

Dimensions in mm.